

IRON BALTIC

PLASTIC SKID PLATE

CAN AM

Outlander 500/700 MAX (2023+)

Code 02.31200

Version 30082023



Keep this manual for future reference!

If you need any spare parts, please send this packaging data to your local dealer or to Iron Baltic sales@ironbaltic.com

DOWNLOAD MULTILINGUAL
USER MANUAL

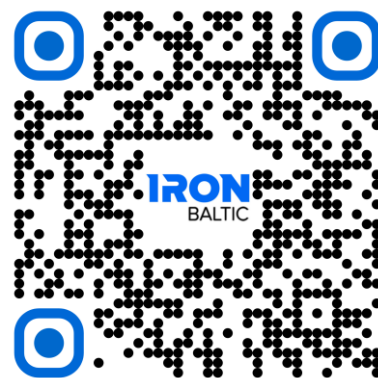

code.ironbaltic.com/u/5OecTk7G

SPECIFICATION

Pos.	Description	Code	Amount
1	Front protection	02.31001K	1
2	Middle protection	02.31202	1
3	Right side protection	02.31203	1
4	Left side protection	02.31204	1
5	Põhjakaitsme tagaosa	02.31005	1
6	Front right arm protection	02.31006	1
7	Front left arm protection	02.31007	1
8	Rear right arm protection	02.31008	1
9	Rear left arm protection	02.31009	1
10	Mounting plate	02.30910	1
11	Installation plate	02.5006	5
12	Installation bracket 1	02.5710	18
13	Installation bracket 2	02.8210	4
14	Installation plate 10°	02.8312	6
15	Angle bracket 80°	02.18805	2
16	Angle bracket 90°	03.1502	2
17	Dished washer	14.503	59
18	Bolt M6x16 DIN933	OT.02.02.050	47
19	Bolt M6x25 DIN933	OT.02.02.070	6
20	Bolt M6x50 DIN933	OT.02.02.120	2
21	Bolt M6x60 DIN933	OT.02.02.140	2
22	Bolt M8x16 DIN933	OT.02.02.170	4
23	Bolt M8x50 DIN933	OT.02.02.240	4
24	Bolt M10x35 DIN933	OT.02.02.329	2
25	Washer Ø6/15 SFS3738	OT.04.03.020	67
26	Washer Ø 8/20 SFS 3738	OT.04.03.030	8
27	Washer Ø 10 DIN125	OT.04.01.040	4
28	Nyloc nut M6 DIN985	OT.03.02.030	10
29	Nyloc nut M8 DIN985	OT.03.02.040	4
30	Nyloc nut M10 DIN985	OT.03.02.050	2



TOOLS REQUIRED FOR INSTALLATION:

- Spanner 10mm
- Spanner 13mm
- Spanner 17mm
- Socket wrench 10mm
- Socket wrench 13mm
- Socket wrench 17mm

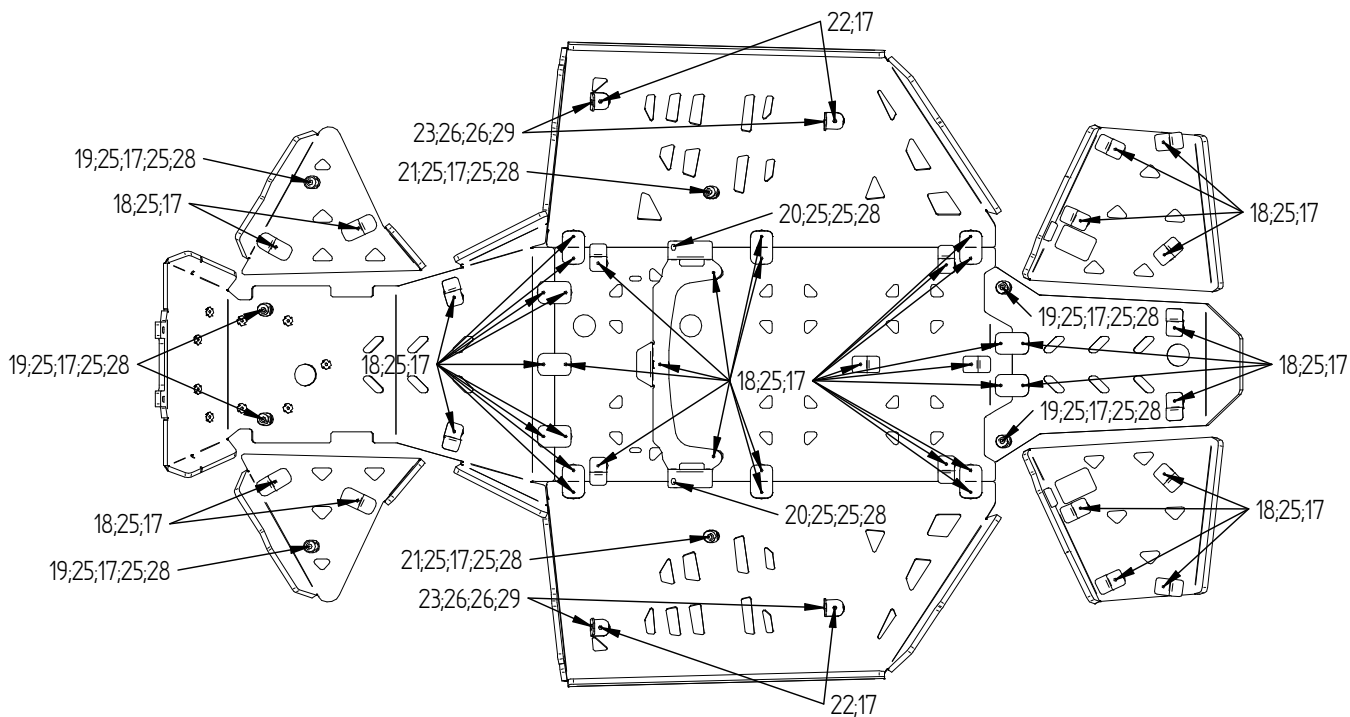
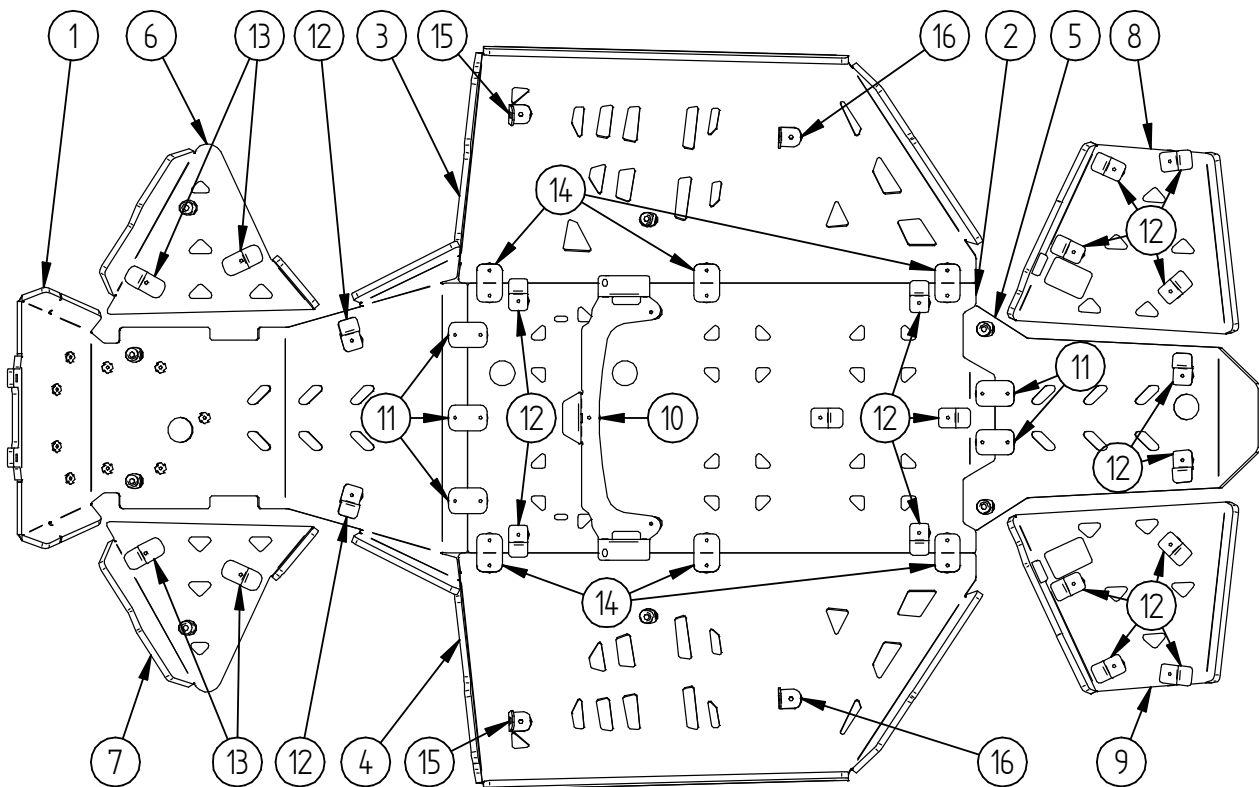

FITTING INSTRUCTIONS



NB!

**We recommend using thread lock fluid on the bolts!
Bolts tend to loosen with vibration from ATV.**

Step 1

Remove all standard plastic covers and bolts shown in the picture, If winch fairlead is installed, remove that as well.

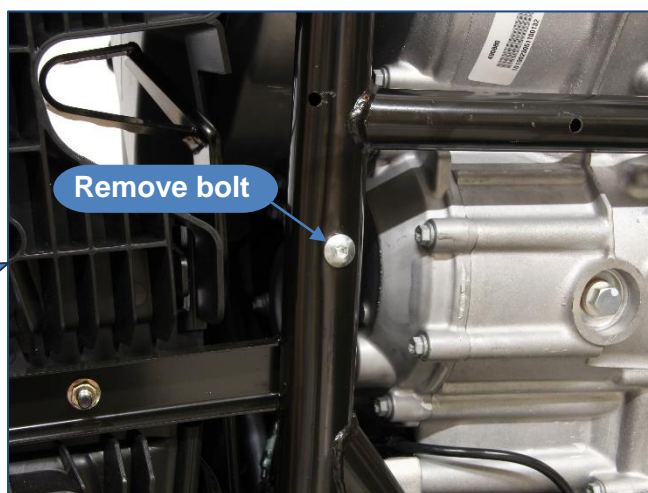
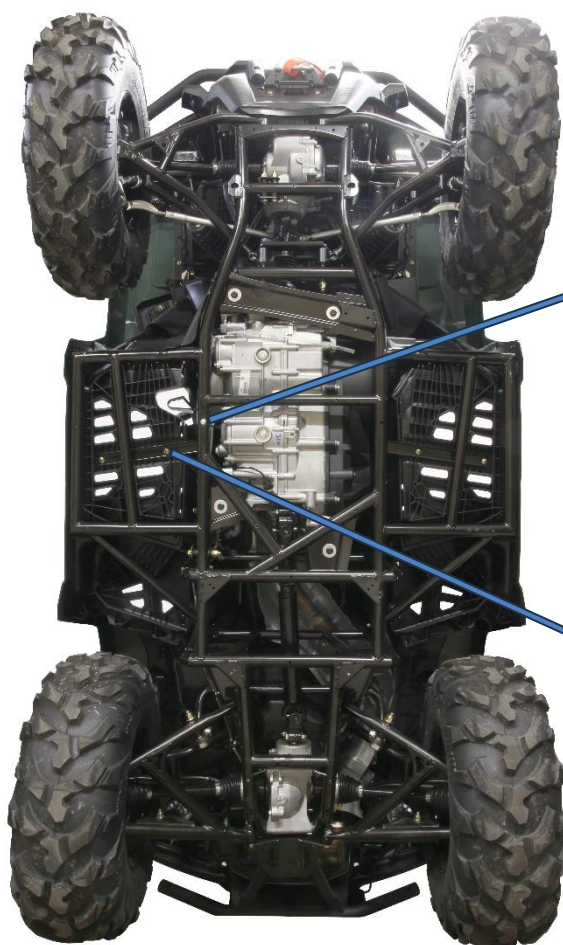

Step 2

Install mounting plate 02.30910. Install brackets 03.1502 and 02.18805.

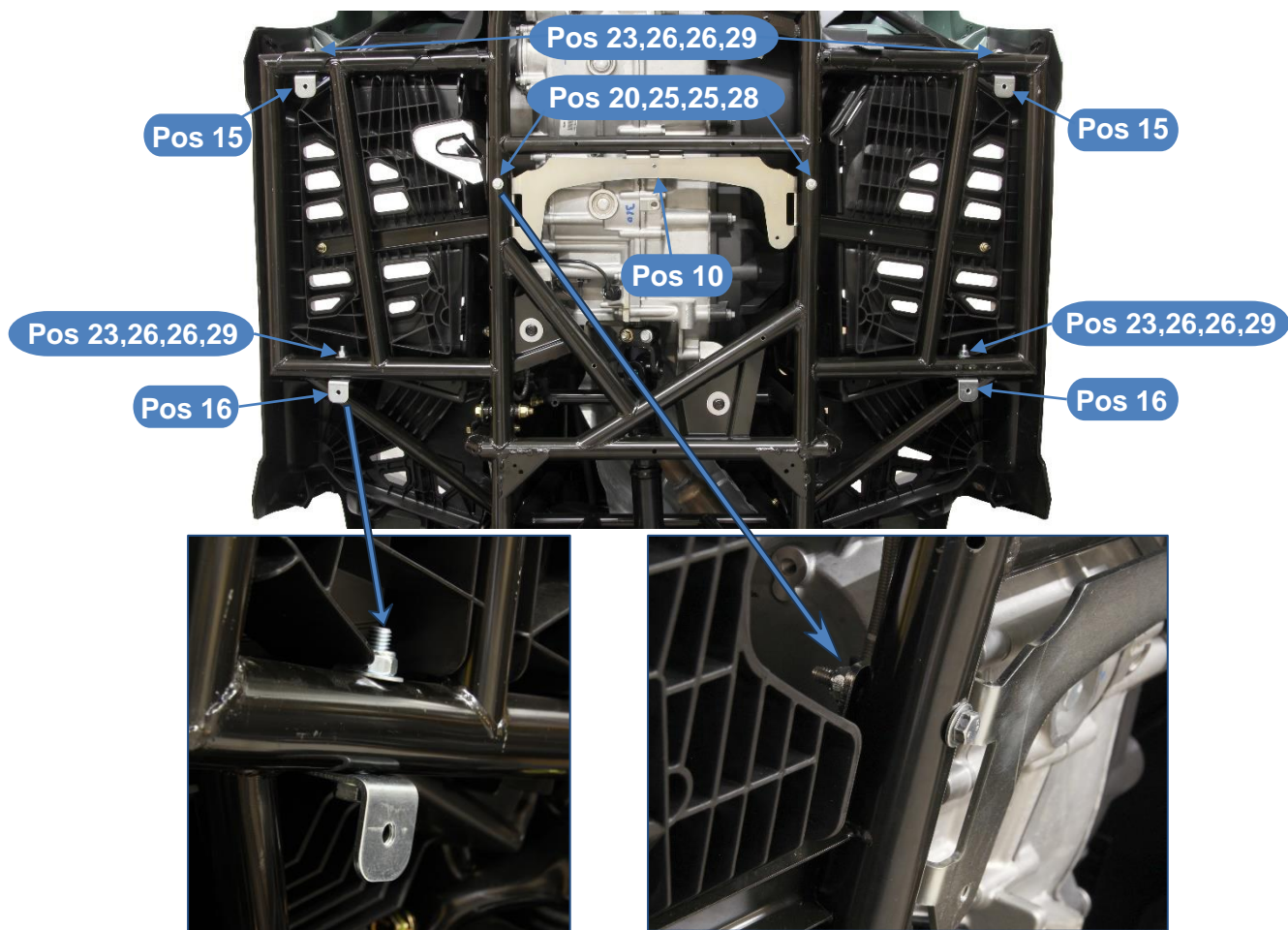

Step 3

Install middle protection 02.31202. Install plates 02.5006 and 02.8312. Use brackets 02.5710 to attach protection to the frame.

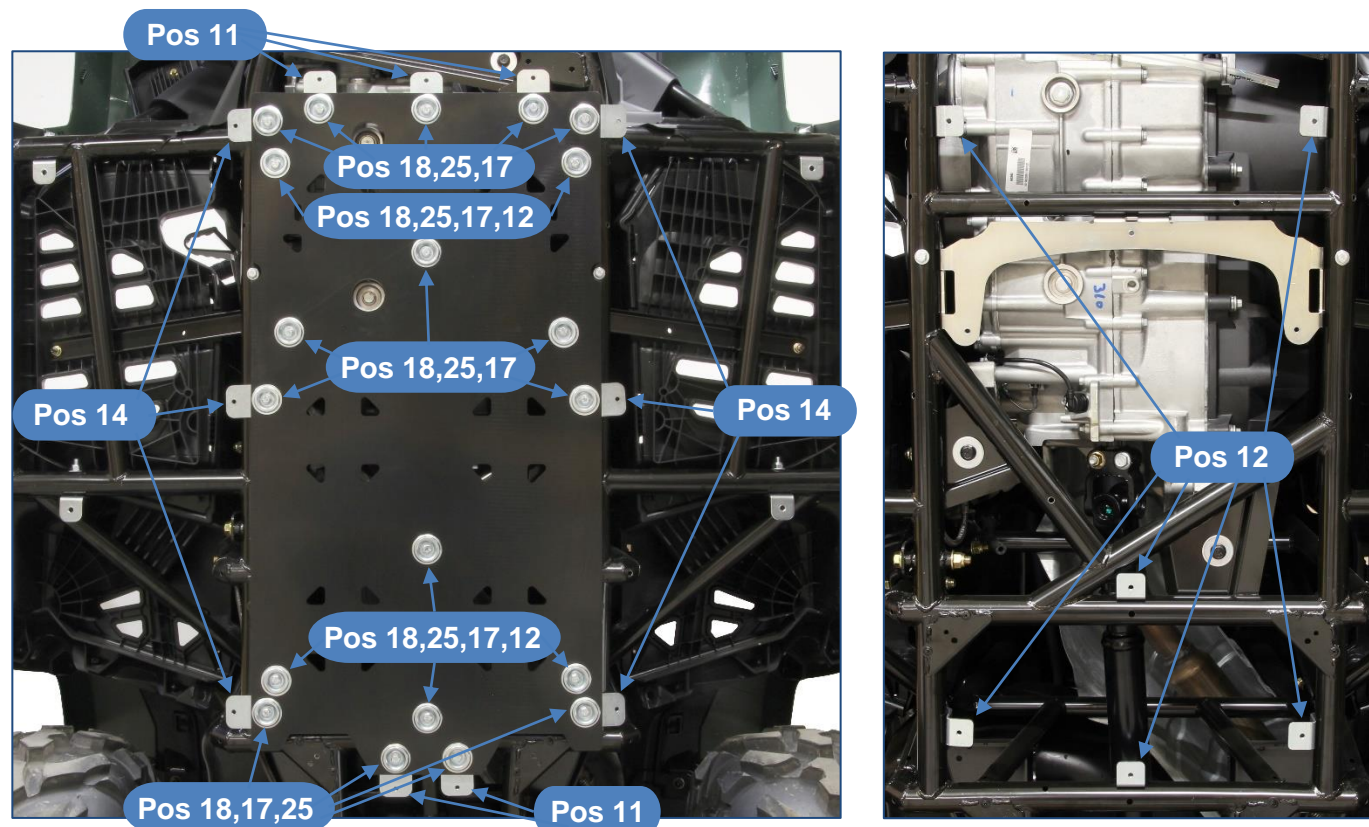

Step 4 Install rear part 02.31005 and brackets 02.5710.

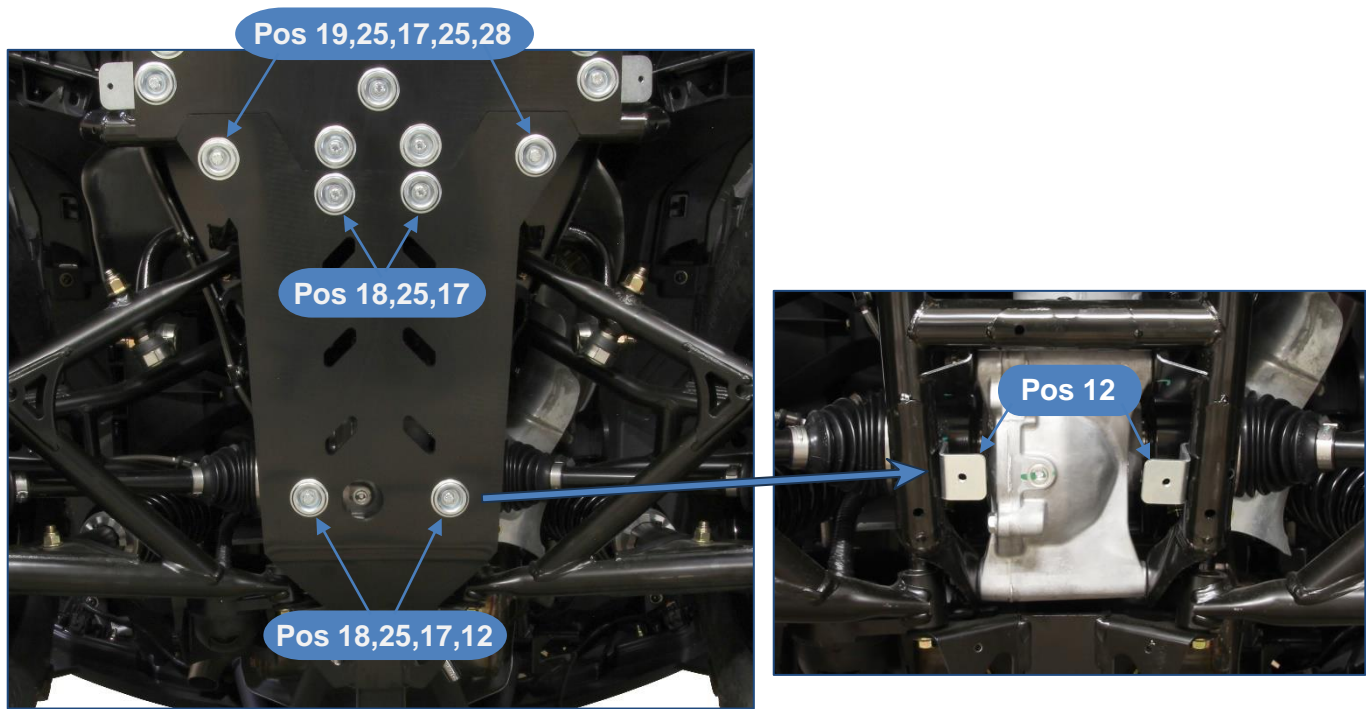

Step 5 Install front protection 02.31001K and brackets 02.5710. Reinstall winch fairlead if it was previously installed.

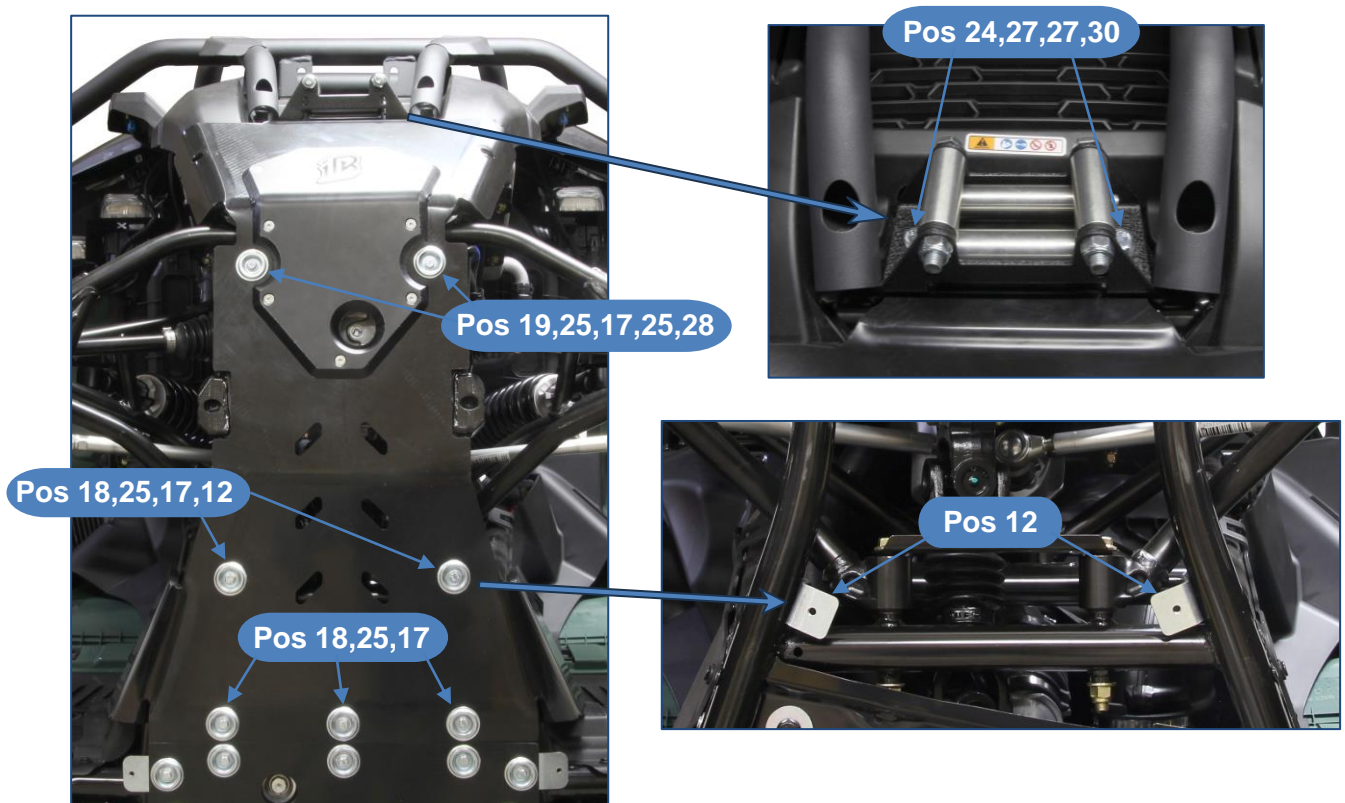

Step 6

Install side protections 02.31203 and 02.31204.

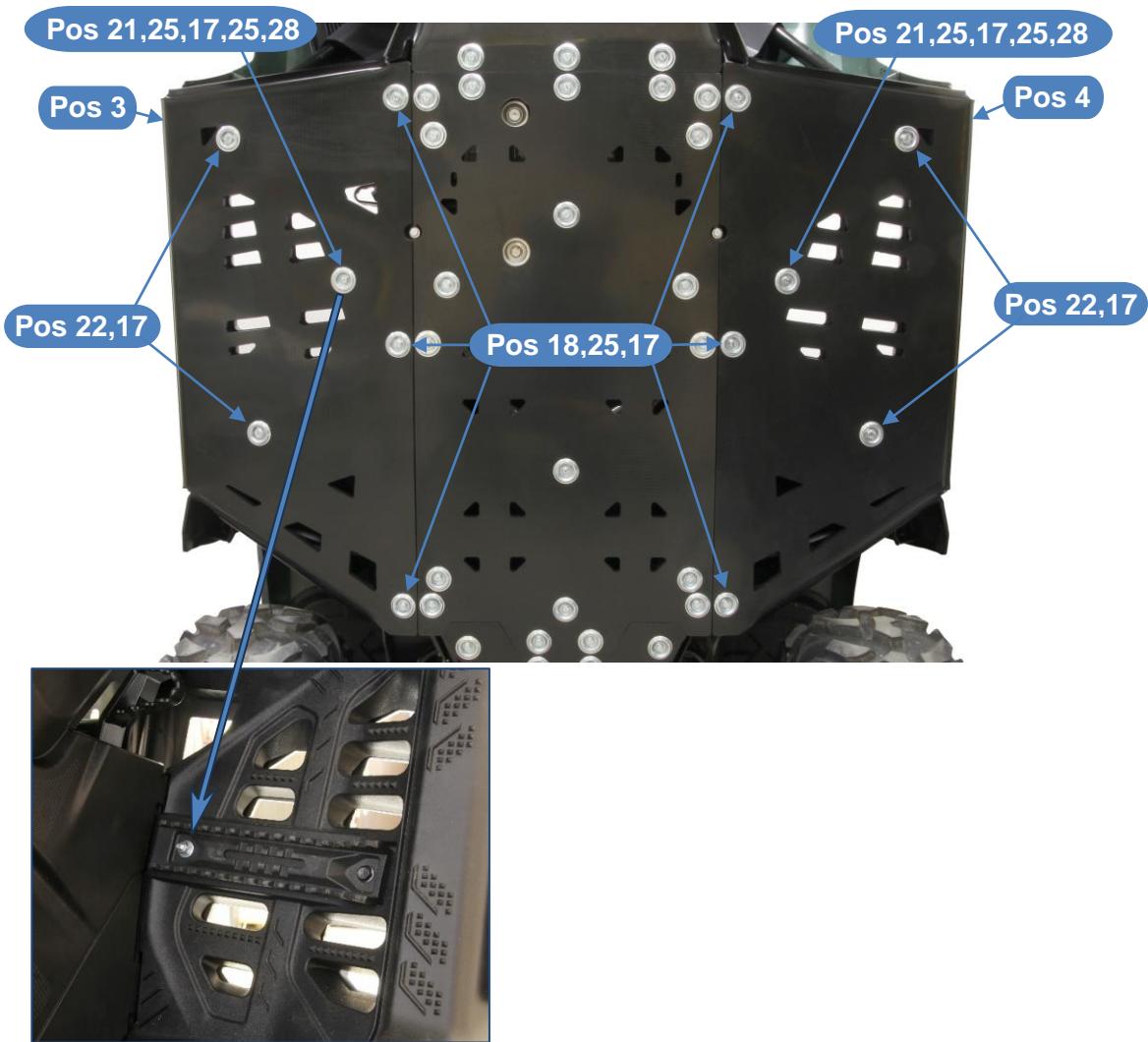

Step 7

Install front arm protections 02.31006 and 02.31007. For installing use brackets 02.8210.

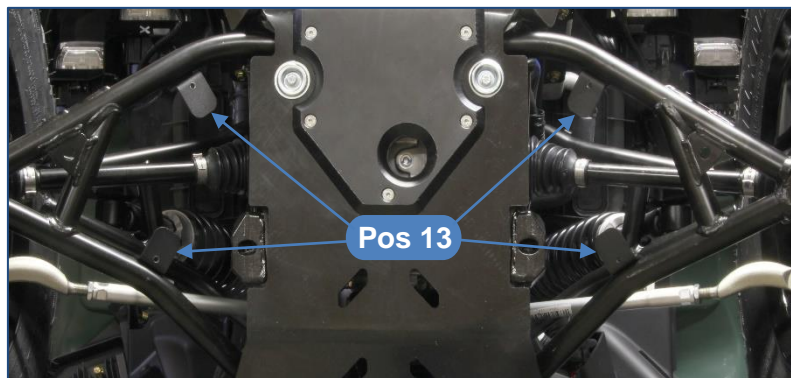
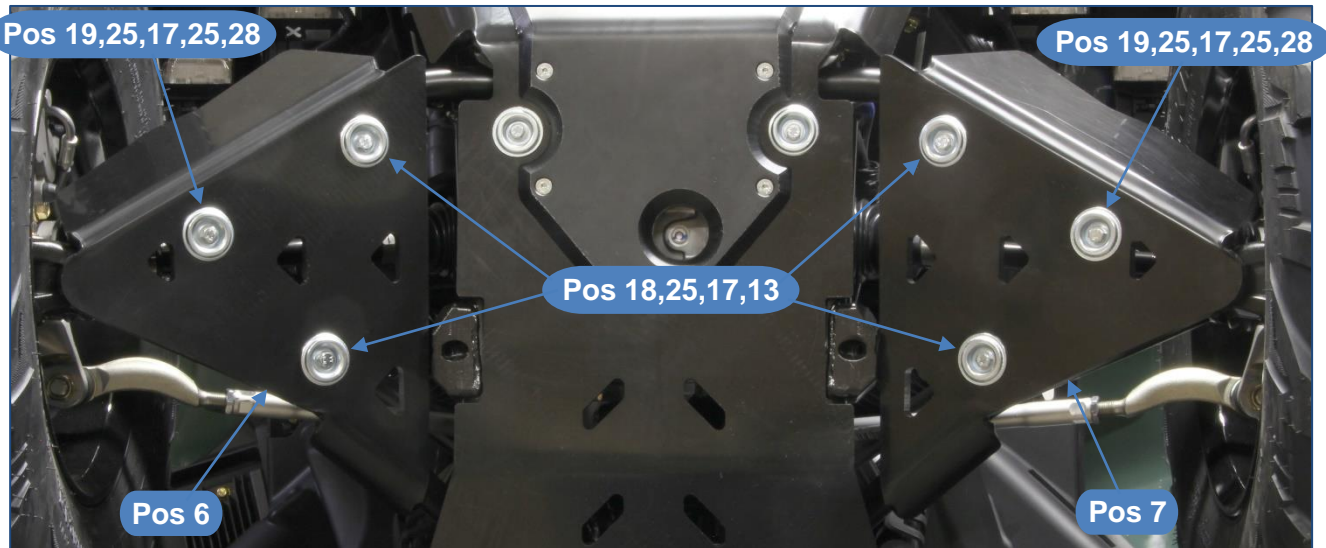

Step 8

Install rear am protections 02.31008 and 02.31009. For installing use brackets 02.5710.

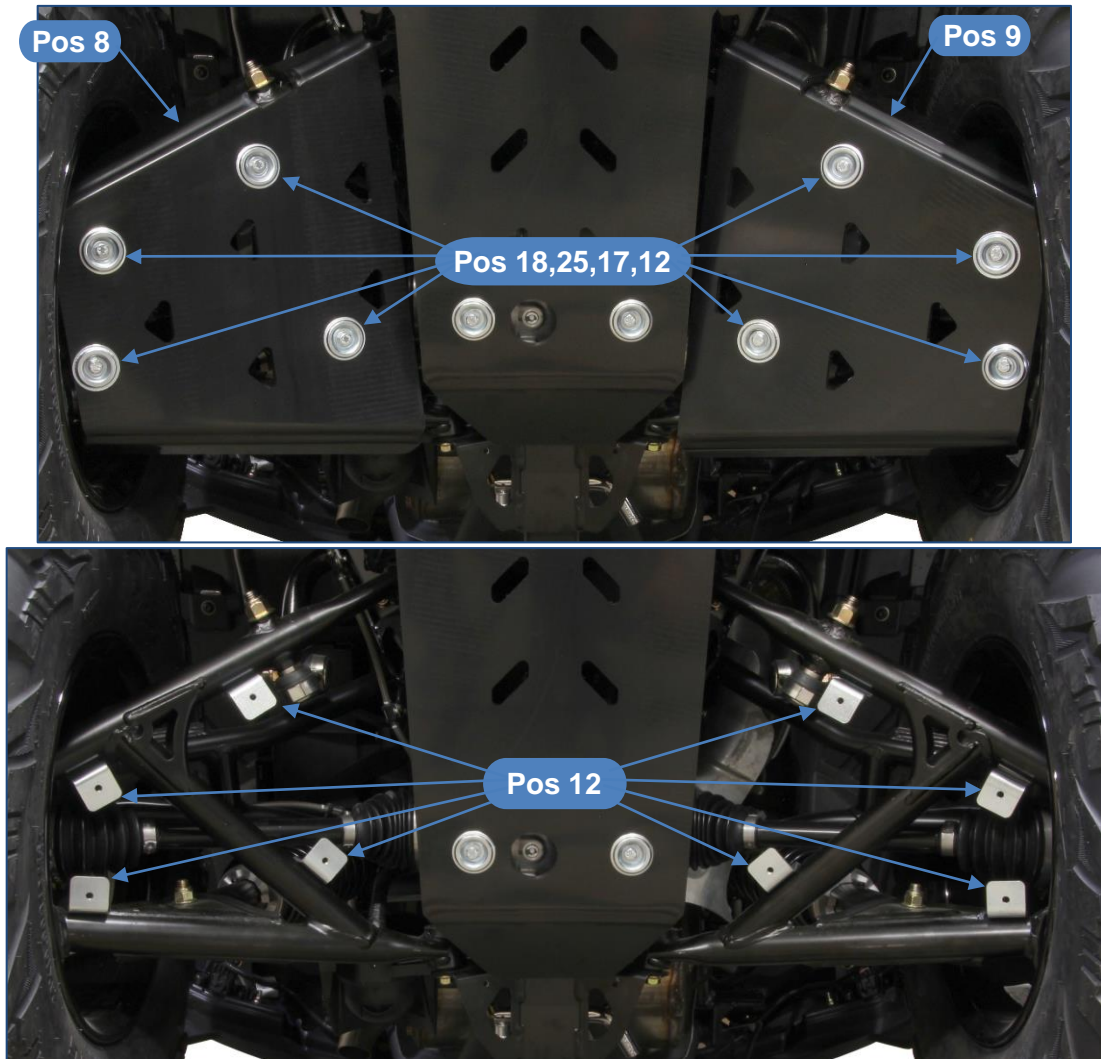

IRON BALTIC

IRON BALTIC OÜ
Joa tee 17
Vääna 76903
Estonia / Europe

+372 6 533 711
sales@ironbaltic.com

www.ironbaltic.com
www.facebook.com/ironbaltic
www.youtube.com/user/ironbalticLtd

